

# MANDRINI PORTA UTENSILI HSK DIN 69893



HSK DIN 69893 TOOL HOLDERS  
WERKZEUGAUFNAHMEN HSK DIN 69893

PORTE-OUTILS HSK DIN 69893  
PORTAHERRAMIENTAS HSK DIN 69893



**Equilibratura: G 6,3 fino a 15.000 giri/minuto.**

*Balanced to G 6,3 at 15.000 rpm.*

Gewuchtet nach G 6,3 bei 15.000 U/min.

*Équilibré G 6,3 jusqu'à 15.000 tours/min.*

Equilibrado G 6,3 hasta 15.000 rpm.

# PORTAFRESA A TRASCINAMENTO FISSO

UNIVERSAL MILLING CUTTER HOLDER  
 AUFSTECKFRAESERDORNE  
 PORTE FRAISE ENTRAINEMENT FIXE  
 PORTA FRESAS UNIVERSAL

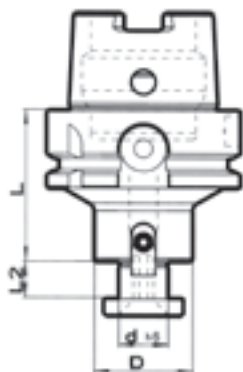

## HSK - A+C

| CODICE<br>CODE<br>BESTELL NR<br>CODE<br>CÓDIGO | ATTACCO<br>SHANK<br>AUFNAHMEN<br>ATTACHEMENT<br>MANGO | d  | D  | L2 | L  |
|--|---|----|----|----|----|
| • 1118.16.H40A                                 | HSK-40A   | 16 | 35 | 17 | 45 |
| • 1118.22.H40A                                 | HSK-40A   | 22 | 50 | 19 | 50 |
| • 1118.27.H40A                                 | HSK-40A   | 27 | 60 | 21 | 55 |
| • 1118.16.H50A                                 | HSK-50A   | 16 | 35 | 17 | 45 |
| • 1118.22.H50A                                 | HSK-50A   | 22 | 50 | 19 | 60 |
| • 1118.27.H50A                                 | HSK-50A   | 27 | 60 | 21 | 60 |
| 1118.16.H63A                                   | HSK-63A   | 16 | 38 | 17 | 50 |
| 1118.22.H63A                                   | HSK-63A   | 22 | 50 | 19 | 50 |
| 1118.27.H63A                                   | HSK-63A   | 27 | 60 | 21 | 60 |
| 1118.32.H63A                                   | HSK-63A   | 32 | 78 | 24 | 60 |
| 1118.40.H63A                                   | HSK-63A   | 40 | 89 | 27 | 60 |
| 1118.22.H100A                                  | HSK-100A  | 22 | 50 | 19 | 50 |
| 1118.27.H100A                                  | HSK-100A  | 27 | 60 | 21 | 50 |
| 1118.32.H100A                                  | HSK-100A  | 32 | 78 | 24 | 50 |
| 1118.40.H100A                                  | HSK-100A  | 40 | 89 | 27 | 60 |

• Disponibile solo su richiesta  
 Available only on demand  
 Verfügbar nur auf Anfrage  
 Disponible seulement sur demande  
 Disponibles bajo petición

### A richiesta combinato.

Kombi on request.

Auf Anfrage Kombi Ausführung.

Sur demande à double usage.

Combinado bajo pedido.

# PORTAPINZA A GRANDE CAPACITA' DI SERRAGGIO PER PINZE DIN 6499

COLLET CHUCK FOR DIN 6499 COLLETS  
SPANNZANGENFUTTER DIN 6499  
PORTE PINCES POUR PINCES DIN 6499  
PORTA PINZAS DIN 6499

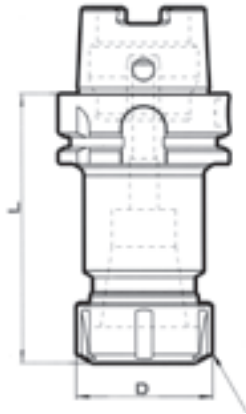

## HSK - A+C

| CODICE<br>CODE<br>BESTELL NR<br>CODE<br>CÓDIGO            | ATTACCO<br>SHANK<br>AUFNAHMEN<br>ATTACHEMENT<br>MANGO | D  | L   | Pinze ER<br>ER Collets<br>Zangen ER<br>Pincas ER<br>Pinzas ER |
|---|---|----|-----|---|
| * 1218.16.H32A  | HSK-32A   | 22 | 80  | 16  |
| * 1218.16.H40A  | HSK-40A   | 22 | 80  | 16  |
| • 1198.25.H40AN   | HSK-40A   | 42 | 80  | 25  |
| • 1198.32.H40AN   | HSK-40A   | 50 | 100 | 32  |
| * 1218.16.H50A  | HSK-50A   | 22 | 100 | 16  |
| • 1198.25.H50AN   | HSK-50A   | 42 | 100 | 25  |
| • 1198.32.H50AN   | HSK-50A   | 50 | 100 | 32  |
| * 1218.16.H63A  | HSK-63A   | 22 | 100 | 16  |
| 1198.25.H63AN   | HSK-63A   | 42 | 100 | 25  |
| 1198.32.H63AN   | HSK-63A   | 50 | 100 | 32  |
| 1198.40.H63AN   | HSK-63A   | 63 | 120 | 40  |
| * 1218.16.H100A   | HSK-100A  | 22 | 160 | 16  |
| 1198.25.H100AN  | HSK-100A  | 42 | 100 | 25  |
| 1198.32.H100AN  | HSK-100A  | 50 | 100 | 32  |
| 1198.40.H100AN  | HSK-100A  | 63 | 120 | 40  |
| <b>Prolungati Extended Verlängerte Prolongé Extendido</b> |   |    |     |   |
| * 2218.16.H40A  | HSK-40A   | 22 | 120 | 16  |
| • 2198.25.H40AN   | HSK-40A   | 42 | 120 | 25  |
| * 2218.16.H63A  | HSK-63A   | 22 | 160 | 16  |
| * 3218.16.H63A  | HSK-63A   | 22 | 200 | 16  |
| 2198.25.H63AN   | HSK-63A   | 42 | 160 | 25  |
| 2198.32.H63AN   | HSK-63A   | 50 | 160 | 32  |
| 2198.40.H63AN   | HSK-63A   | 63 | 160 | 40  |
| 2198.25.H100AN  | HSK-100A  | 42 | 160 | 25  |
| 2198.32.H100AN  | HSK-100A  | 50 | 160 | 32  |
| 2198.40.H100AN  | HSK-100A  | 63 | 160 | 40  |

• Disponibile solo su richiesta  
Available only on demand  
Verfügbar nur auf Anfrage  
Disponibile seulement sur demande  
Disponibles bajo petición

\*Forniti con ghiera mini cod. 9131.16.22  
Supplied with mini nut code 9131.16.22  
Lieferumfang komplett mit Minimutter  
9131.16.22  
Fourni avec bague mini 9131.16.22  
Entregado con tuerca mini 9131.16.22

Per utensili a gambo cilindrico/For cylindrical shank tools  
Zur Aufnahme von Werkzeugen mit Zylinderschaft in Spannzangen.  
Pour outils avec queue cylindrique/Para herramientas de mango cilíndrico

# PORTAPINZA A GRANDE CAPACITA' DI SERRAGGIO PER PINZE DIN 6499

COLLET CHUCK FOR DIN 6499 COLLETS

SPANNZANGENFUTTER DIN 6499

PORTE PINCES POUR PINCES DIN 6499

PORTA PINZAS DIN 6499

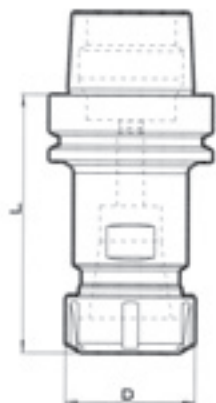

HSK - E

| CODICE<br>CODE<br>BESTELL NR<br>CODE<br>CÓDIGO            | ATTACCO<br>SHANK<br>AUFNAHMEN<br>ATTACHEMENT<br>MANGO | D  | L   | Pinze ER<br>ER Collets<br>Zangen ER<br>Pincas ER<br>Pinzas ER |
|---|---|----|-----|---|
| * 1218.16.H40E  | HSK-40E   | 22 | 80  | 16  |
| • 1198.25.H40EN   | HSK-40E   | 42 | 80  | 25  |
| • 1198.32.H40EN   | HSK-40E   | 50 | 100 | 32  |
| * 1218.16.H50E  | HSK-50E   | 22 | 100 | 16  |
| • 1198.25.H50EN   | HSK-50E   | 42 | 100 | 25  |
| • 1198.32.H50EN   | HSK-50E   | 50 | 100 | 32  |
| * 1218.16.H63E  | HSK-63E   | 22 | 100 | 16  |
| • 1198.25.H63EN   | HSK-63E   | 42 | 100 | 25  |
| • 1198.32.H63EN   | HSK-63E   | 50 | 100 | 32  |
| • 1198.40.H63EN   | HSK-63E   | 63 | 120 | 40  |
| <b>Prolungati Extended Verlängerte Prolongé Extendido</b> |   |    |     |   |
| * 2218.16.H40E  | HSK-40E   | 22 | 120 | 16  |
| * 2218.16.H63E  | HSK-63E   | 22 | 160 | 16  |
| • 2198.25.H40EN   | HSK-40E   | 42 | 120 | 25  |
| • 2198.25.H63EN   | HSK-63E   | 42 | 160 | 25  |
| • 2198.32.H63EN   | HSK-63E   | 50 | 160 | 32  |
| • 2198.40.H63EN   | HSK-63E   | 63 | 160 | 40  |

• Disponibile solo su richiesta  
Available only on demand  
Verfügbar nur auf Anfrage  
Disponible seulement sur demande  
Disponibles bajo petición

## Per utensili a gambo cilindrico

For cylindrical shank tools

Zur Aufnahme von Werkzeugen mit Zylinderschaft in Spannzangen.

Pour outils avec queue cylindrique.

Para herramientas de mango cilíndrico

## \* Forniti con ghiera mini cod. 9131.16.22

Supplied with mini nut code 9131.16.22

Lieferbar zusammen mit Mini mutter 9131.16.22

Fourni avec bague mini 9131.16.22

Entregado con tuerca mini 9131.16.22

# PORTAFRESA WELDON

END MILL HOLDER WELDON  
FRÄSERSPANNFUTTER WELDON  
MANDRIN PORTE FRAISES À QUEUE WELDON  
PORTAFRESAS TIPO WELDON

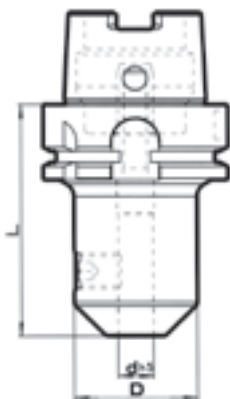

## HSK - A+C

| CODICE<br>CODE<br>BESTELL NR<br>CODE<br>CÓDIGO | ATTACCO<br>SHANK<br>AUFNAHMEN<br>ATTACHEMENT<br>MANGO | d  | D  | L   |
|--|---|----|----|-----|
| • 1248.06.H32A                                 | HSK-32A   | 6  | 25 | 60  |
| • 1248.08.H32A                                 | HSK-32A   | 8  | 28 | 60  |
| • 1248.10.H32A                                 | HSK-32A   | 10 | 35 | 65  |
| • 1248.06.H40A                                 | HSK-40A   | 6  | 25 | 60  |
| • 1248.08.H40A                                 | HSK-40A   | 8  | 28 | 60  |
| • 1248.10.H40A                                 | HSK-40A   | 10 | 35 | 60  |
| • 1248.12.H40A                                 | HSK-40A   | 12 | 42 | 70  |
| • 1248.14.H40A                                 | HSK-40A   | 14 | 44 | 75  |
| • 1248.16.H40A                                 | HSK-40A   | 16 | 48 | 75  |
| • 1248.20.H40A                                 | HSK-40A   | 20 | 52 | 80  |
| • 1248.06.H50A                                 | HSK-50A   | 6  | 25 | 65  |
| • 1248.08.H50A                                 | HSK-50A   | 8  | 28 | 65  |
| • 1248.10.H50A                                 | HSK-50A   | 10 | 35 | 65  |
| • 1248.12.H50A                                 | HSK-50A   | 12 | 42 | 80  |
| • 1248.14.H50A                                 | HSK-50A   | 14 | 44 | 80  |
| • 1248.16.H50A                                 | HSK-50A   | 16 | 48 | 80  |
| • 1248.18.H50A                                 | HSK-50A   | 18 | 50 | 80  |
| • 1248.20.H50A                                 | HSK-50A   | 20 | 52 | 80  |
| • 1248.25.H50A                                 | HSK-50A   | 25 | 64 | 110 |
| 1248.06.H63A                                   | HSK-63A   | 6  | 25 | 65  |
| 1248.08.H63A                                   | HSK-63A   | 8  | 28 | 65  |
| 1248.10.H63A                                   | HSK-63A   | 10 | 35 | 65  |
| 1248.12.H63A                                   | HSK-63A   | 12 | 42 | 80  |

• Disponibile solo su richiesta  
Available only on demand  
Verfügbar nur auf Anfrage  
Disponible seulement sur demande  
Disponibles bajo petición

SEGUE  
CONTINUE

For Weldon end mill with cylindrical shank DIN 1835  
Zum Spannen von zylindrischen Werkzeugschäften nach DIN 1835  
Pour fraises avec attachement cylindrique DIN 1835  
Para fresa de mango cilíndrico con weldon DIN 1835

# PORTAFRESA WELDON

END MILL HOLDER WELDON  
FRÄSERSPANNFUTTER WELDON  
MANDRIN PORTE FRAISES À QUEUE WELDON  
PORTAFRESAS TIPO WELDON

SEGUE  
CONTINUE

## HSK - A+C

| CODICE<br>CODE<br>BESTELL NR<br>CODE<br>CÓDIGO | ATTACCO<br>SHANK<br>AUFNAHMEN<br>ATTACHEMENT<br>MANGO | d  | D  | L   |
|--|---|----|----|-----|
| 1248.14.H63A                                   | HSK-63A   | 14 | 44 | 80  |
| 1248.16.H63A                                   | HSK-63A   | 16 | 48 | 80  |
| 1248.18.H63A                                   | HSK-63A   | 18 | 50 | 80  |
| 1248.20.H63A                                   | HSK-63A   | 20 | 52 | 80  |
| 1248.25.H63A                                   | HSK-63A   | 25 | 64 | 110 |
| 1248.32.H63A                                   | HSK-63A   | 32 | 64 | 110 |
| 1248.06.H100A                                  | HSK-100A  | 6  | 25 | 80  |
| 1248.08.H100A                                  | HSK-100A  | 8  | 28 | 80  |
| 1248.10.H100A                                  | HSK-100A  | 10 | 35 | 80  |
| 1248.12.H100A                                  | HSK-100A  | 12 | 42 | 80  |
| 1248.14.H100A                                  | HSK-100A  | 14 | 44 | 80  |
| 1248.16.H100A                                  | HSK-100A  | 16 | 48 | 100 |
| 1248.18.H100A                                  | HSK-100A  | 18 | 48 | 100 |
| 1248.20.H100A                                  | HSK-100A  | 20 | 52 | 100 |
| 1248.25.H100A                                  | HSK-100A  | 25 | 64 | 100 |
| 1248.32.H100A                                  | HSK-100A  | 32 | 72 | 100 |

# PORTAFRESA WELDON PROLUNGATO

END MILL HOLDER WELDON EXTENDED  
FRÄSERSPANNFUTTER WELDON VERLÄNGERT  
MANDRIN PORTE FRAISES À QUEUE WELDON ALLONGÉ  
PORTAFRESAS TIPO WELDON EXTENDIDO

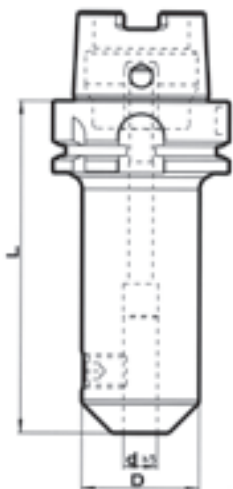

## HSK - A+C

| CODICE<br>CODE<br>BESTELL NR<br>CODE<br>CÓDIGO     | ATTACCO<br>SHANK<br>AUFNAHMEN<br>ATTACHEMENT<br>MANGO | d  | D  | L   |
|--|---|----|----|-----|
| Prolungati Extended Verlängerte Prolongé Extendido |   |    |    |     |
| 2248.06.H63A                                       | HSK-63A   | 6  | 25 | 100 |
| 2248.08.H63A                                       | HSK-63A   | 8  | 28 | 100 |
| 2248.10.H63A                                       | HSK-63A   | 10 | 35 | 100 |
| 2248.12.H63A                                       | HSK-63A   | 12 | 42 | 120 |
| 2248.14.H63A                                       | HSK-63A   | 14 | 44 | 120 |
| 2248.16.H63A                                       | HSK-63A   | 16 | 48 | 120 |
| 2248.18.H63A                                       | HSK-63A   | 18 | 50 | 120 |
| 2248.20.H63A                                       | HSK-63A   | 20 | 52 | 120 |
| 2248.25.H63A                                       | HSK-63A   | 25 | 64 | 150 |
| 2248.32.H63A                                       | HSK-63A   | 32 | 72 | 150 |
| 2248.06.H100A                                      | HSK-100A  | 6  | 25 | 120 |
| 2248.08.H100A                                      | HSK-100A  | 8  | 28 | 120 |
| 2248.10.H100A                                      | HSK-100A  | 10 | 35 | 120 |
| 2248.12.H100A                                      | HSK-100A  | 12 | 42 | 120 |
| 2248.14.H100A                                      | HSK-100A  | 14 | 44 | 120 |
| 2248.16.H100A                                      | HSK-100A  | 16 | 48 | 150 |
| 2248.18.H100A                                      | HSK-100A  | 18 | 50 | 120 |
| 2248.20.H100A                                      | HSK-100A  | 20 | 52 | 150 |
| 2248.25.H100A                                      | HSK-100A  | 25 | 64 | 150 |
| 2248.32.H100A                                      | HSK-100A  | 32 | 72 | 150 |

For Weldon end mill with cylindrical shank DIN 1835  
Zum Spannen von zylindrischen Werkzeugschaften nach DIN 1835  
Pour fraises avec attachement cylindrique DIN 1835  
Para fresa de mango cilíndrico con weldon DIN 1835

# PORTAFRESA WELDON

END MILL HOLDER WELDON

FRÄSERSPANNFUTTER WELDON

MANDRIN PORTE FRAISES À QUEUE WELDON

PORTAFRESAS TIPO WELDON

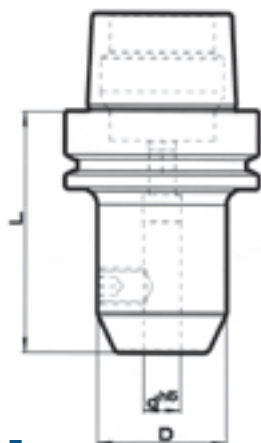

## HSK - E

| CODICE<br>CODE<br>BESTELL NR<br>CODE<br>CÓDIGO | ATTACCO<br>SHANK<br>AUFNAHMEN<br>ATTACHEMENT<br>MANGO | d  | D  | L   |
|--|---|----|----|-----|
| • 1248.06.H40E                                 | HSK-40E   | 6  | 25 | 60  |
| • 1248.08.H40E                                 | HSK-40E   | 8  | 28 | 60  |
| • 1248.10.H40E                                 | HSK-40E   | 10 | 35 | 60  |
| • 1248.12.H40E                                 | HSK-40E   | 12 | 42 | 70  |
| • 1248.14.H40E                                 | HSK-40E   | 14 | 44 | 75  |
| • 1248.16.H40E                                 | HSK-40E   | 16 | 48 | 75  |
| • 1248.20.H40E                                 | HSK-40E   | 20 | 52 | 80  |
| • 1248.06.H50E                                 | HSK-50E   | 6  | 25 | 65  |
| • 1248.08.H50E                                 | HSK-50E   | 8  | 28 | 65  |
| • 1248.10.H50E                                 | HSK-50E   | 10 | 35 | 65  |
| • 1248.12.H50E                                 | HSK-50E   | 12 | 42 | 80  |
| • 1248.14.H50E                                 | HSK-50E   | 14 | 44 | 80  |
| • 1248.16.H50E                                 | HSK-50E   | 16 | 48 | 80  |
| • 1248.20.H50E                                 | HSK-50E   | 20 | 52 | 80  |
| • 1248.25.H50E                                 | HSK-50E   | 25 | 64 | 110 |
| • 1248.06.H63E                                 | HSK-63E   | 6  | 25 | 65  |
| • 1248.08.H63E                                 | HSK-63E   | 8  | 28 | 65  |
| • 1248.10.H63E                                 | HSK-63E   | 10 | 35 | 65  |
| • 1248.12.H63E                                 | HSK-63E   | 12 | 42 | 80  |
| • 1248.14.H63E                                 | HSK-63E   | 14 | 44 | 80  |
| • 1248.16.H63E                                 | HSK-63E   | 16 | 48 | 80  |
| • 1248.18.H63E                                 | HSK-63E   | 18 | 50 | 80  |
| • 1248.20.H63E                                 | HSK-63E   | 20 | 52 | 80  |
| • 1248.25.H63E                                 | HSK-63E   | 25 | 64 | 110 |
| • 1248.32.H63E                                 | HSK-63E   | 32 | 64 | 110 |

- Disponibile solo su richiesta  
Available only on demand  
Verfügbar nur auf Anfrage  
Disponible seulement sur demande  
Disponibles bajo petición

For Weldon end mill with cylindrical shank DIN 1835

Zum Spannen von zylindrischen Werkzeugschaften nach DIN 1835

Pour fraises avec attachement cylindrique DIN 1835

Para fresa de mango cilíndrico con weldon DIN 1835



# RIDUZIONI A CONO MORSE PER PUNTE DIN 228-B

MORSE TAPER ADAPTER FOR TWIST DRILLS DIN 228-B  
ZWISCHENHULSEN FÜR BOHRER DIN 228-B  
REDUCTION CONE MORSE POUR FORETS DIN 228-B  
ADAPTADOR CONO MORSE PARA BROCAS DIN 228-B

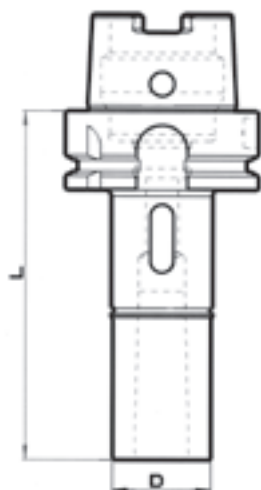

## HSK - A+C

| CODICE<br>CODE<br>BESTELL NR<br>CODE<br>CÓDIGO | ATTACCO<br>SHANK<br>AUFNAHMEN<br>ATTACHEMENT<br>MANGO | Cono Morse<br>Morse cone<br>Innenkegel<br>Cone Morse<br>Cono Morse | D  | L   |
|--|---|--|----|-----|
| • 1308.01.H40A                                 | HSK-40A   | 1  | 25 | 95  |
| • 1308.02.H40A                                 | HSK-40A   | 2  | 32 | 110 |
| • 1308.03.H40A                                 | HSK-40A   | 3  | 40 | 135 |
| • 1308.01.H50A                                 | HSK-50A   | 1  | 25 | 100 |
| • 1308.02.H50A                                 | HSK-50A   | 2  | 32 | 115 |
| • 1308.03.H50A                                 | HSK-50A   | 3  | 40 | 135 |
| 1308.01.H63A                                   | HSK-63A   | 1  | 25 | 100 |
| 1308.02.H63A                                   | HSK-63A   | 2  | 32 | 115 |
| 1308.03.H63A                                   | HSK-63A   | 3  | 40 | 135 |
| 1308.04.H63A                                   | HSK-63A   | 4  | 48 | 160 |
| 1308.02.H100A                                  | HSK-100A  | 2  | 32 | 120 |
| 1308.03.H100A                                  | HSK-100A  | 3  | 40 | 150 |
| 1308.04.H100A                                  | HSK-100A  | 4  | 48 | 170 |

- Disponibile solo su richiesta  
*Available only on demand*  
Verfügbar nur auf Anfrage  
*Disponible seulement sur demande*  
Disponibles bajo petición

# RIDUZIONE A CONO MORSE PER FRESE DIN 228-A

MORSE TAPER ADAPTER FOR MILLING CUTTERS DIN 228-A

ZWISCHENHULSEN FÜR FRÄSER DIN 228-A

REDUCTION CONE MORSE POUR FRAISES DIN 228-A

ADAPTADOR CONO MORSE PARA FRESAS DIN 228-A

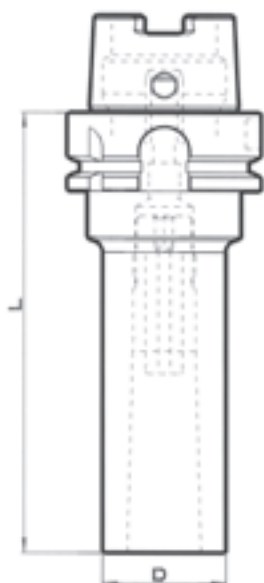

## HSK - A+C

| CODICE<br>CODE<br>BESTELL NR<br>CODE<br>CÓDIGO | ATTACCO<br>SHANK<br>AUFNAHMEN<br>ATTACHEMENT<br>MANGO | Cono Morse<br>Morse cone<br>Innenkegel<br>Cone Morse<br>Cono Morse | D  | L   |
|--|---|--|----|-----|
| • 1338.01.H40A                                 | HSK-40A   | 1  | 25 | 95  |
| • 1338.02.H40A                                 | HSK-40A   | 2  | 32 | 110 |
| • 1338.03.H40A                                 | HSK-40A   | 3  | 40 | 135 |
| • 1338.01.H50A                                 | HSK-50A   | 1  | 25 | 100 |
| • 1338.02.H50A                                 | HSK-50A   | 2  | 32 | 115 |
| • 1338.03.H50A                                 | HSK-50A   | 3  | 40 | 135 |
| 1338.01.H63A                                   | HSK-63A   | 1  | 25 | 105 |
| 1338.02.H63A                                   | HSK-63A   | 2  | 32 | 116 |
| 1338.03.H63A                                   | HSK-63A   | 3  | 40 | 145 |
| 1338.04.H63A                                   | HSK-63A   | 4  | 48 | 165 |
| 1338.02.H100A                                  | HSK-100A  | 2  | 32 | 120 |
| 1338.03.H100A                                  | HSK-100A  | 3  | 40 | 150 |
| 1338.04.H100A                                  | HSK-100A  | 4  | 48 | 170 |

- Disponibile solo su richiesta  
*Available only on demand*  
Verfügbar nur auf Anfrage  
*Disponible seulement sur demande*  
Disponibles bajo petición

# ATTACCO MODULARE

MODULAR SHANK  
STEILKEGELADAPTER  
ATTACHEMENT MODULAIRE  
MANGO MODULAR

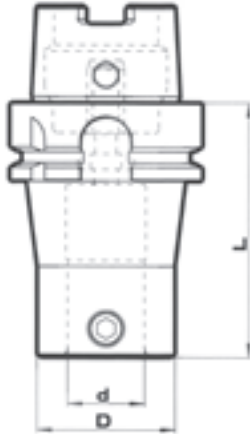

## HSK - A+C

| CODICE<br>CODE<br>BESTELL NR<br>CODE<br>CÓDIGO | ATTACCO<br>SHANK<br>AUFNAHMEN<br>ATTACHEMENT<br>MANGO | d  | L   | D  |
|--|---|----|-----|----|
| • 1808.25.H50A                                 | HSK-50A   | 25 | 82  | 42 |
| 1808.25.H63A                                   | HSK-63A   | 25 | 84  | 45 |
| • 1808.25.H80A                                 | HSK-80A   | 25 | 87  | 45 |
| • 1808.40.H80A                                 | HSK-80A   | 40 | 106 | 66 |
| 1808.25.H100A                                  | HSK-100A  | 25 | 89  | 45 |
| 1808.40.H100A                                  | HSK-100A  | 40 | 110 | 66 |

- Disponibile solo su richiesta  
*Available only on demand*  
Verfügbar nur auf Anfrage  
*Disponible seulement sur demande*  
Disponibles bajo petición

# BARRE A STELO TENERO

BLANK TOOL - HOLDER

ROHLINGE ZUR BEARBEITUNG VON SONDERAUSFÜHRUNGEN

BARRES D'ALESAGE SEMI-FINIES

BARRAS CON MANGO BLANDO

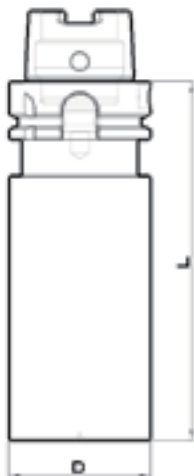

## HSK - A+C

| CODICE<br>CODE<br>BESTELL NR<br>CODE<br>CÓDIGO | ATTACCO<br>SHANK<br>AUFNAHMEN<br>ATTACHEMENT<br>MANGO | D   | L   |
|--|---|-----|-----|
| • 2600.63.H63A                                 | HSK-63A   | 63  | 250 |
| • 2600.97.H100A                                | HSK-100A  | 100 | 250 |

- Disponibile solo su richiesta  
*Available only on demand*  
Verfügbar nur auf Anfrage  
*Disponible seulement sur demande*  
Disponibles bajo petición

# BARRE A STELO TENERO

BLANK TOOL - HOLDER

ROHLINGE ZUR BEARBEITUNG VON SONDERAUSFÜHRUNGEN

BARRES D'ALESAGE SEMI-FINIES

BARRAS CON MANGO BLANDO

HSK DIN 69893 CON DUREZZA HRC42  
SHANK HSK DIN 69893 WITH HARDNESS HRC42  
AUFNAHME HSK DIN 69893 MIT HÄRTE HRC42  
ATTACHEMENT HSK DIN 69893 DURETÉ HRC42  
MANGO HSK DIN 69893 CON DUREZZA HRC42

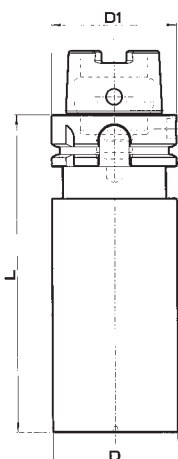

## HSK - A

| CODICE<br>CODE<br>BESTELL NR<br>CODE<br>CÓDIGO | ATTACCO<br>SHANK<br>AUFNAHMEN<br>ATTACHEMENT<br>MANGO | D   | D1  | L   |
|--|---|-----|-----|-----|
| 1620.63.H63A                                   | HSK-63A   | 63  | 63  | 160 |
| 2620.63.H63A                                   | HSK-63A   | 63  | 63  | 250 |
| 1620.100.H100A                                 | HSK-100A  | 100 | 100 | 160 |
| 2620.100.H100A                                 | HSK-100A  | 100 | 100 | 250 |

## HSK - C

| CODICE<br>CODE<br>BESTELL NR<br>CODE<br>CÓDIGO | ATTACCO<br>SHANK<br>AUFNAHMEN<br>ATTACHEMENT<br>MANGO | D  | D1 | L   |
|--|---|----|----|-----|
| 1620.63.H63C                                   | HSK-63C   | 63 | 63 | 160 |